

BLAUPUNKT

TYRE PRESSURE MONITORING SYSTEM

TPMS IN-DASH USB 4.2

Wireless USB receiver compatible with Android OS radios



Fast/Slow leakage alarm | High temperature alarm | High / Low pressure alarm

Enjoy it.

Display

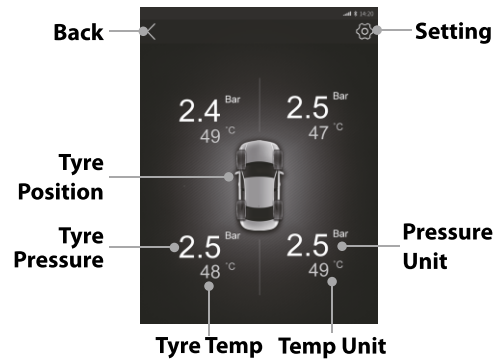

Includes

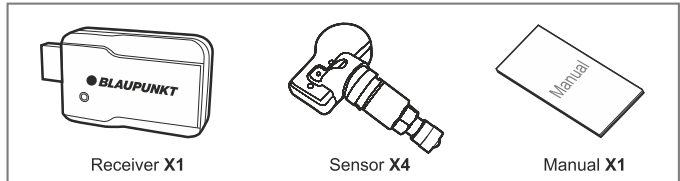

APP ON/OFF

APP ON

Insert the USB dongle into the USB port of the radio, then open the app to display TPMS related information on the radio screen.



Note:

- The APP needs to have been installed in the radio before inserting the dongle in the USB port
- The tyre data will be shown on the display automatically once the radio is turned ON.
- The tyre data will be shown on the radio display automatically if there is any abnormal status.

APPOFF

Remove the dongle from the USB port of the radio. Blaupunkt TPMS APP is now disconnected.

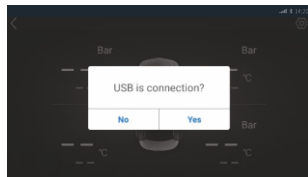

Different scenarios

Setting Parameters:

1. Click on the TPMS icon



2. Select Function setting

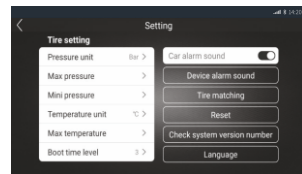

3. Pressure unit: Select the tyre pressure unit - PSI / Bar



4. Max pressure: Select the desired pressure value (please, refer to "Specification" & adjust the value). Check the vehicle user manual for recommended tyre pressure

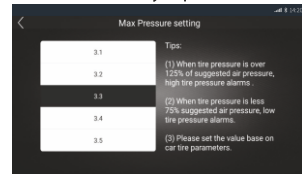

9. Car alarm sound: Select the system warning voice-ON / OFF Note: If the voice alarm is turned OFF, there will be no audible warning should there be an alarm from the sensors.

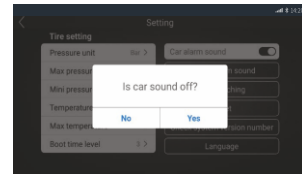

10. Device alarm sound: Select the receiver warning - ON / OFF Note: If the alarm is turned OFF, there will be no audible warning should there be an alarm from the sensors.

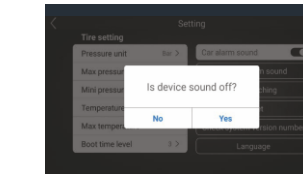

5. Min pressure: Select the low pressure value (Please refer to "Specification" and adjust the value)

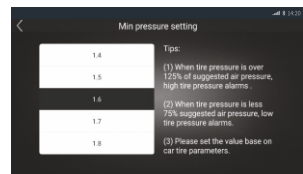

6. Temperature: Select the tyre temperature unit - °C/°F

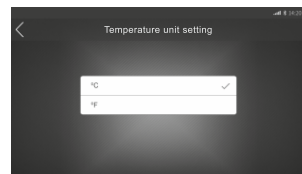

7. Max temperature: Select the high temperature value (Please refer to "Specification" adjust the value)

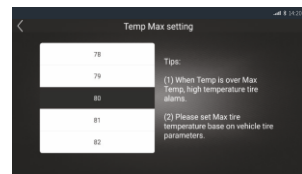

8. Boot time level: Higher the value, this will decide the duration of time the tyre information will appear on the main screen of the radio after it's turned ON

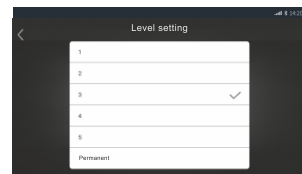

11. Tyre programming method: There are three programming methods to program the sensors (Please refer to "Sensor programming" reprogram the sensors)

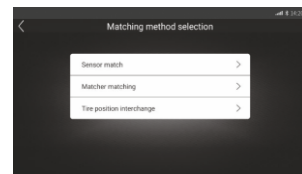

12. Reset: Restore factory default values - ON / OFF Note: When the speed exceeds 25km/h, real-time tyre data will be shown on the interface automatically

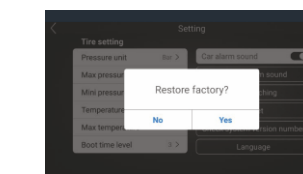

Receiver Installation

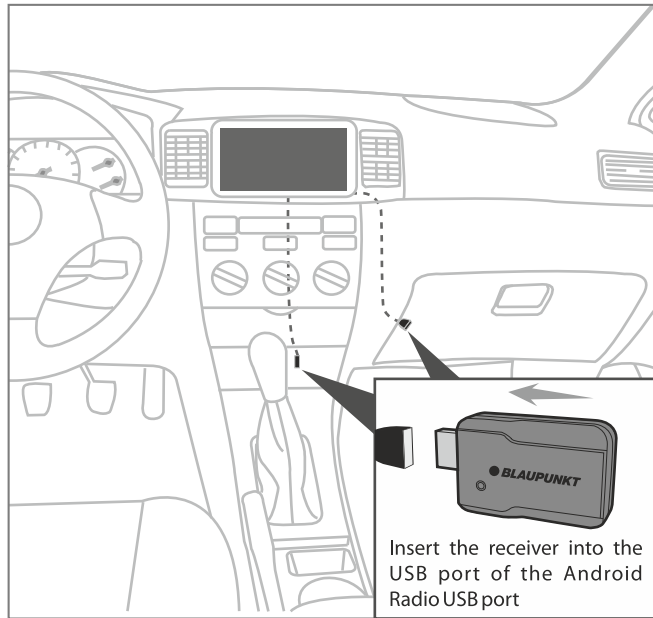

Sensor Installation

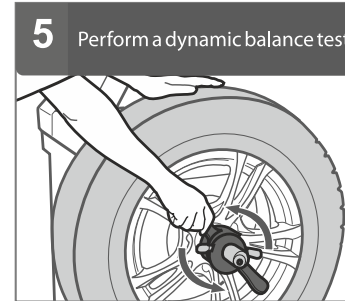
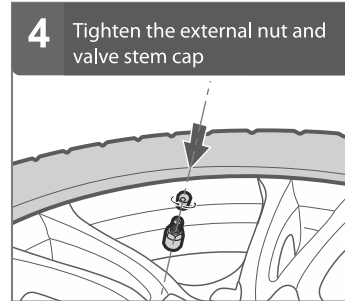
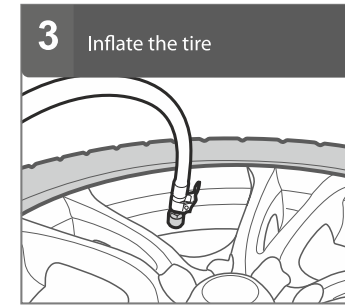
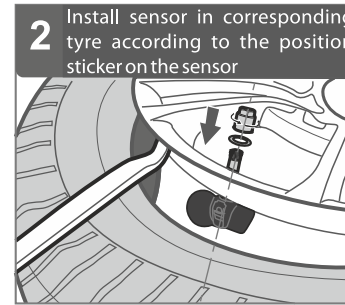
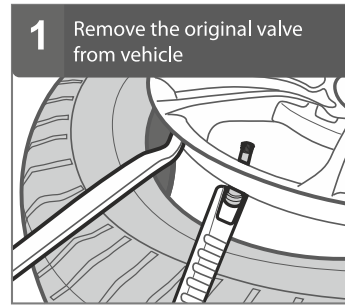
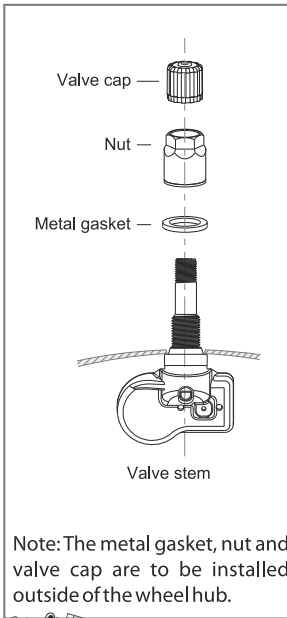

Functional test after installation

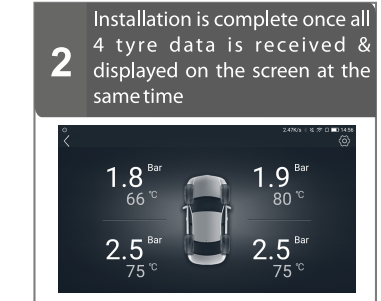
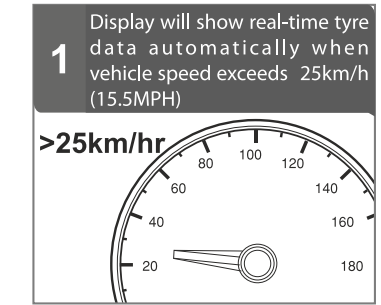

Specification

Receiver	
Operating frequency:	433.92±0.05MHZ
Operating voltage:	5±0.5V
Operating current:	516mA (at normal status) 5100mA (at warning status)
Operating temperature:	-20°C ~+70°C /-4F~+158F
Pressure range:	0-8Bar/0-116PSI
Sensor	
Operating frequency:	433.92±0.015MHZ
Operating voltage:	2.3-3.6V
Static current:	50.8uA
Operating temperature:	-30 °C~+105°C/-22°F ~+221°F
Adjustable value range	
High pressure value:	2.6-6.0Bar /37-86PSI
Low pressure value:	0.9-3.9Bar /13-55PSI
High temperature value:	70-90°C /158-194°C
Default value	
High pressure value:	3.3Bar /47PSI
Low pressure value:	1.7Bar /24PSI
High temperature:	80°C /176°C
Precision	
Pressure:	±0.1 Bar/ ±2PSI
Air pressure unit	
1 Bar = 14.5PSI = 100KPa = 1.02 K.f/cm	

Sensor programing (Reminder: All sensors are pre-programmed)

The system needs to be reprogrammed only when the sensor or receiver is replaced.

Click on the icon "⊙", then select the "Tyre matching", there are three programming methods to commence programming.

1. Sensor match

A. Select "Sensor match" to enter the programming mode.

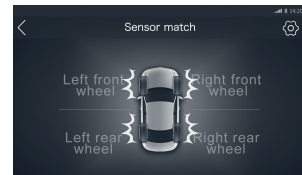

B. Click on the tyre icon you need to reprogram, and then the icon should turn green

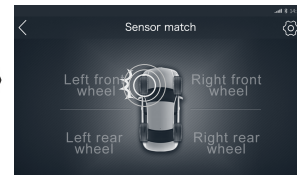

C. Inflate the corresponding tyre until the tyre data is shown on the display

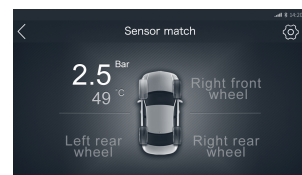

D. Program the next sensor according as per step B & C, then click on the icon "<" to save and exit programming

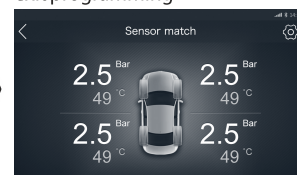

Disclaimer

- Tyre Pressure Monitoring System (TPMS) is designed for monitoring tire irregularities.
- Driver has responsibility to maintain tyres regularly
- Driver should react promptly once a warning is received from the TPMS kit
- Blaupunkt does no guarantee or assume liability for the loss of sensors

Notes

- This system is for vehicles with tyre pressure rating within 6.0Bar / 86PSI.
- All sensors in this unit have been set individually for each tire at the factory.
- Whenever the location of tyre changes, the sensors must be reprogrammed to the corresponding tyre location.
- The display will turn OFF after the vehicle is turned OFF.
- The battery life of the sensor depends on the use of the vehicle.
- The approval mark and numbers which should be kept permanently, will not affect its installation and functions.
- Do not expose the sensor battery to high temperature or direct flame.
- Do not allow the sensor battery to get wet or store in high humidity conditions. This could cause the battery to malfunction.
- Do not disassemble or tamper with battery in the individual sensors.
- During installation of the sensor tighten the outside nut slowly with 4.0Nm (±0.5) torque in one direction to avoid damaging the sensor.

Troubleshooting

1. After installation, there is no tyre data on the display

- The sensors were not programmed to the display, please reprogram the sensors
- The display should show the real time tyre data automatically once the speed exceeds 25km/h

2. There is no tyre data on the display

- The sensors are not programmed to the display, please reprogram it
- There is a problem with the sensor

3. The system has a problem if this icon "... appears occasionally

- The signal that is transmitted from the sensor is a RF signal and is much like a cell phone signal. The FCC requires to allow all other RF signals to interfere with the system signals and this can cause the monitor to occasionally not display information from the sensors. If this persists then you could have a damaged sensor or the batteries could be weak.

4. Pop up message "USB is connection?" automatically in Blaupunkt TPMS APP.

- Please make sure that if there is other TPMS APP on the original car system

BPIN Private Limited

47, Atlanta Society, Nariman Point, Mumbai - 400 021.

Maharashtra, India.

Toll Free: 1800 209 6820 | info@blaupunktcar.in

Shop Online at www.blaupunktcar.in

Warranty

Dear Customer,

Thank you for buying Blaupunkt. To get yourself familiarized with the features and operation of the unit, we suggest you to read the Operating instruction manual provided along with the unit. This Warranty Card is an assurance that you have purchased the best. Please preserve this card to avail Warranty Service during the unlikely event of any problem.

Warranty:

Your Blaupunkt Tyre Inflator is fully guaranteed against manufacturing defects or material defect for the period of **12 (Twelve) months** from the date of sale, satisfying the terms & conditions given below. Equipment in need of Service should be referred to an authorized Blaupunkt Dealer or Service Center.

Warranty Terms & Conditions:

- Warranty will be entertained only when this card and the original invoice or sale receipt (as proof of date of purchase, model, serial no. and the dealer's name) is presented together with the product requiring attention.
- Warranty does not cover damage to Blaupunkt item caused by accident, misuse, unauthorized repairs, additions and modifications carried out by unauthorized dealers or if tampered in any other manner.
- Warranty will not apply if the type or serial number on the product has been altered, deleted, removed or made illegible.
- Warranty does not cover periodic maintenance or replacement of parts due to normal wear & tear.
- This warranty does not cover problem due to improper installation and setup adjustment.
- We reserve the right to refuse warranty service if the above terms and conditions are violated.
- The extent of this warranty is limited only upto the value of the Blaupunkt equipment under warranty.
- In case of any legal or other disputes the same will be under the Courts in Mumbai jurisdiction.

0422

WARRANTY CARD - Tyre Pressure Monitoring System

Please demand the below portion is filled by the dealer and given to you.

Model: TPMS IN-DASH USB 4.2

Part Number: 1102146000-001

Date of Purchase:

Dealer's Stamp:

