

Txt 10A Active Bass Tube

Technical data

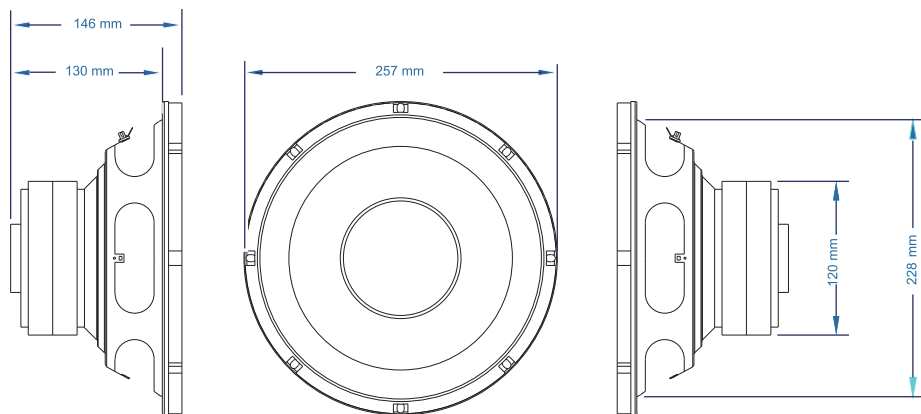
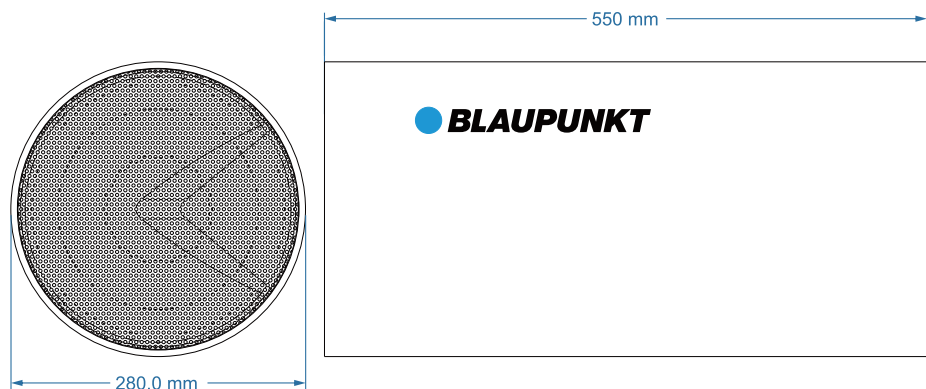

Specifications

- Subwoofer: 10" (250mm)
- Integrated Amplifier: 120 watts RMS | 600 watts Peak Power
- Amplifier Type: Class A/B
- Enclosure Type: Bass Tube (Rear Vented)
- Nominal Impedance: 4 Ohms
- Frequency Response: Amplifier: 25Hz – 250Hz | Speaker: 25Hz – 3KHz
- Tone Controls: GAIN & BASS BOOST (0,+6,+12dB at 45Hz)
- Signal Input: Low Level (RCA Pair) / High Level – Left / Right
- Cooling: Convection
- Visual Indicators: POWER / PROTECT
- Crossover Controls: Variable 40Hz – 250Hz
- Phase Selectable: 0° – 180°
- DC Offset Built In: Auto Turn ON
- Fuse Rating: 25A
- Secure Hold Down Nylon straps included
- External Bass Controller included in packaging
- Dimensions: 21.65" x 11"

BPIN Private Limited

148 Jolly Maker Chamber No. II, 225 Nariman Point, Mumbai – 400 021.India.

Toll Free: 1800 209 6820 | www.blaupunktcars.in / www.blaupunkt.com

BLAUPUNKT

Sound | Active Subwoofer
Txt 10A Active Bass Tube



Enjoy it.



Txt 10A Active Bass Tube

Warranty

We provide a manufacturer's warranty for our products bought within India. You can view the warranty terms at www.blaupunktcar.in or ask for them directly at:

BPIN Private Limited

148 Jolly Maker Chamber No. II,

225 Nariman Point, Mumbai – 400 021.India.

Safety Notes:

Please observe the following safety notes during the installation & connection.

- Disconnect the negative terminal of the battery. Observe safety notes of the vehicle manufacturer.
- Prior to drilling mounting holes, make sure that no cables & parts of the vehicle will be damaged.
- Do not install subwoofers on loose rear parcel shelves (fastback vehicles)
- Leave ample clearance between the cables and other harnesses. Use cable glands for holes with sharp edges

Connection Diagram

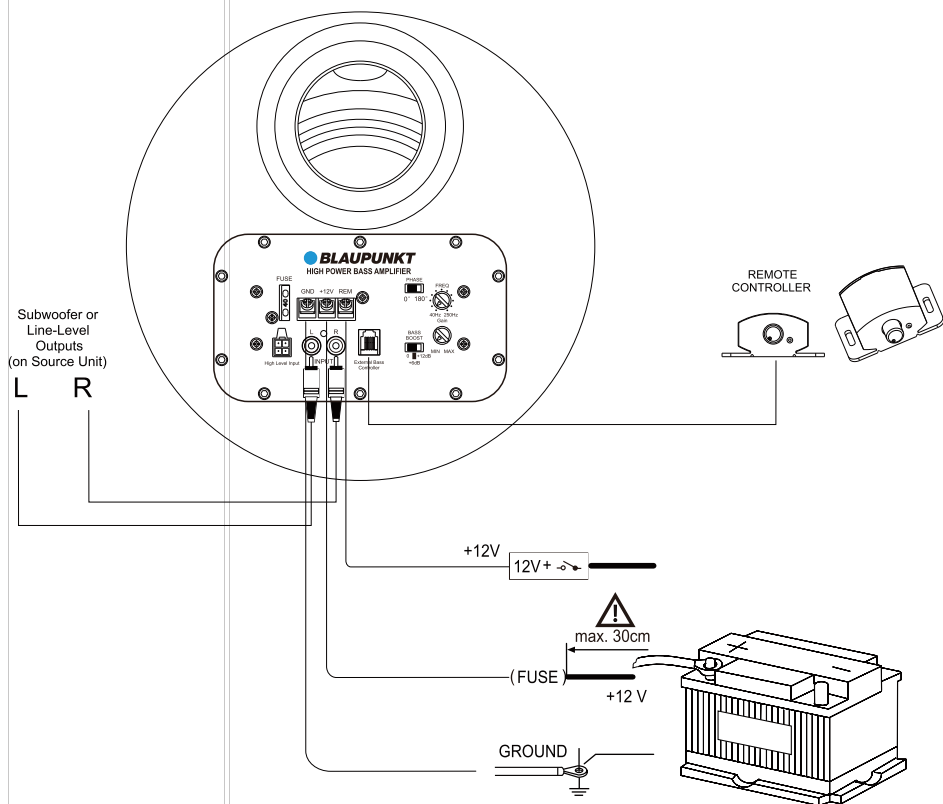

Txt 10A Active Bass Tube

- This Active bass tube is equipped with a 40A fuse onboard to protect circuitry in case of a fault.
- **+12V:** Please use an 8ga or 10ga (minimum) wire direct from the battery and connect to the +12V terminal. Ensure that there is a 40A fuse near the battery when connecting power cable directly to the battery.
- **Remote Turn- on:** If a Blue remote turn on wire is available from the radio (aftermarket), please connect it to connect to the REM terminal. If there is no Blue remote turn on wire and the high - level input option is used, there is no need to connect the REM terminal as it is equipped with DC Offset option and will turn on once the factory radio is switched on
- **Ground:** Connect the GND cable to a location near the device. Keep GND cable length as short as possible. It is recommended that this device be grounded to a solid metal part.
- **Phase:** 0 or 180 is an option that can be selected once the installation of this device is completed and during final listening set up – user can select either option. This is to help keep the subwoofer in phase with the other speakers in the cabin
- **Crossover:** Use the Frequency dial to help fine tune the crossover point that is best suited to user's listening taste. Recommended is 80-90Hz
- **Input Configuration:** This bass tube comes equipped with a high - level input or RCA level input option. Pick one input option to connect this subwoofer to the radio
- **Bass Boost:** This subwoofer is equipped with a toggle switch that allows user to dial in the preferred amount of bass. Options are 0 (flat), +6 or +12dB
- **External Bass Controller:** Please connect the external bass controller provided in the packaging to help dial in the quantum of bass easily from the cabin. This controller allows user fast and easy access to increase or decrease bass levels.
- **Gain:** It is recommended to keep the Gain control at a reasonable level when using either the high – level or RCA level input options. If the high – level input option is selected, the Gain dial can be kept to a minimum or just a couple of notches above minimum. Same applies for aftermarket radios with hi volt (4V or 5V) pre - out (RCA). If the radio has a 2V RCA pre - out, Gain can be increased to around 45-50% of the dial.

Speaker Features

- Powerful 120 watt Class A/B amplifier powering a high end 10" subwoofer
- Rear Vented Bass Tube for cabin filling sound
- Covered with carpet and stylish grille
- DC Offset built in for easy integration with OE radios
- One box solution to add big bass in a vehicle

Recycling and disposal



To dispose of the product, please use the available waste return and collection systems.



Subject to changes!